

Piazza Suite

Living Space 635 sq ft
Bedroom 243 sq ft
Total 878 sq ft

CES 2019

January 8-11

Venetian Tower Exhibit Suites

Exhibitors will have the option to remove the beds only. No other furniture will be removed from the suite. Exhibitors will have the option of hiring Venetian Facility Services to move furnishings around within the suite or moved into the restroom for storage. A Venetian furniture movement fee will apply. Exhibitors are not permitted to move furnishings on their own. A fine will be assessed if this policy is broken. There are a limited number of items which cannot be moved including the armoire and entertainment center. Please refer to your Exhibitor Manual for additional rules and regulations. Thank You!

KEY:



= Lamp



= Window

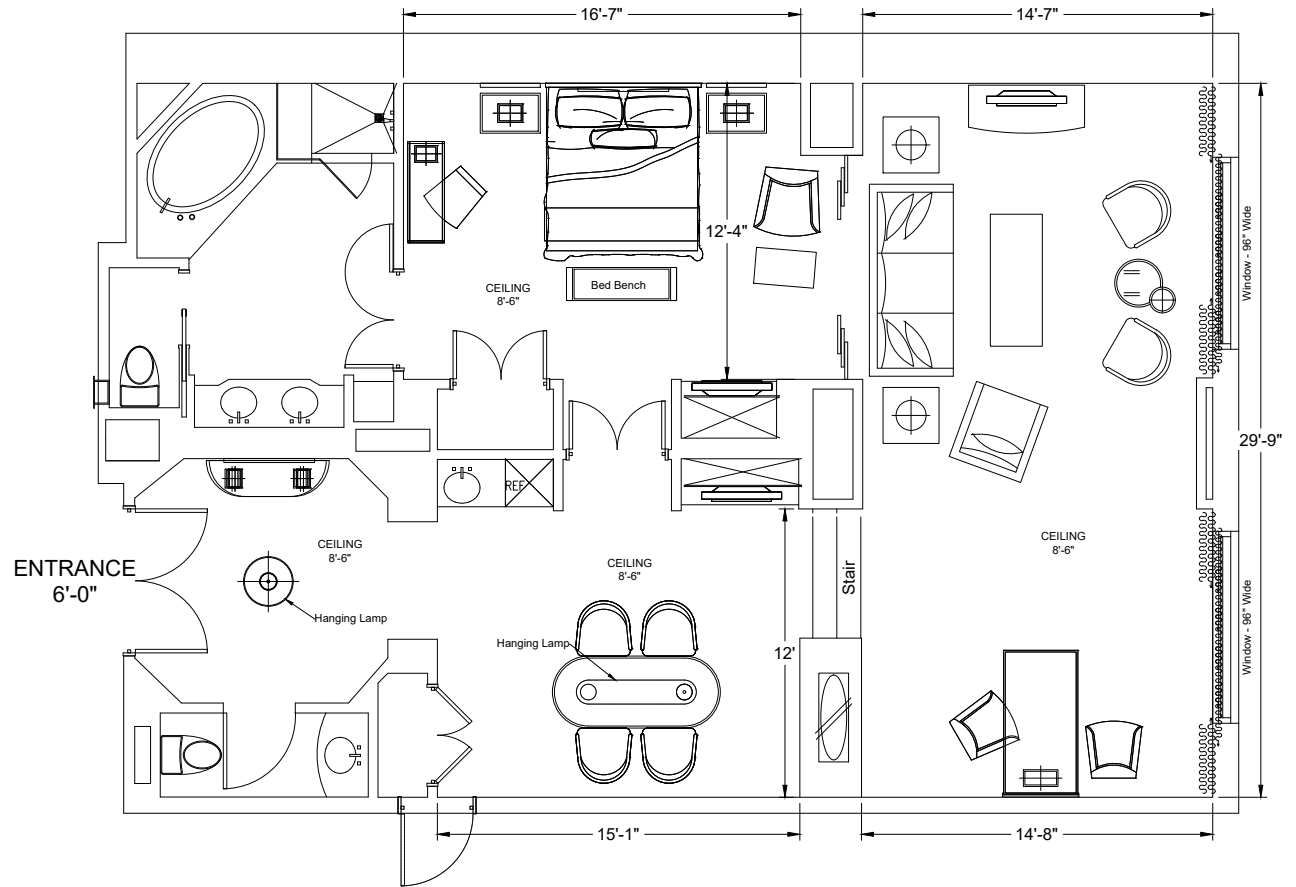

- Please note there are two layouts - the version you see above and the mirror-image.
- All dimensions are approximate and subject to vary in size per suite.
- Exhibitor may check-in on Sunday, January 6 and must check-out on Saturday, January 12.

FREEMAN

Disclaimer - Every effort has been made to ensure the accuracy of all information contained on this floor plan. However, no warranties, either expressed or implied, are made with respect to this floor plan. If the location of building columns, utilities or other architectural components of the facility is a consideration in the construction or usage of an exhibit, it is the sole responsibility of the exhibitor to physically inspect the facility to verify all dimension and locations. © Copyright 2007, freeman, all rights reserved.
Confidential and Proprietary - the information contained herein is the proprietary information of Freeman and by accessing the information, the recipient agrees to keep the information confidential and not disclose it to any third party without the prior consent of Freeman. Recipient also agrees to only use the information for its internal evaluation purposes and for no other purpose, without the prior consent of Freeman.

Drawing Started:
2/2/2018

Started By:
KRISTAL K. MILLER, NRDC

Account Exec:
KEVIN COLLURA
Producing Exec:
JANET DAVILA

Revision Date:
2/2/2018

Revised By:
KRISTAL K. MURO, NRDC

Line Item:
#4429719
Scale:
1/8" = 1'-0"